

- Addition counters
- 1 preselection
- 2, 4 or 6 decade devices
- LED indicator, green



Order code

KCX-2DM-V

KCX-4DM-V

KCX-6DM-V

Technical data

General data

Preselection  
Data storage

Controls and indicators

Type  
Number of decade devices  
Digit height  
Preselection

Inputs

Counting frequency  
Minimum pulse duration  
Input impedance  
Input voltage

Delay times

External reset  
Automatic reset  
Time delay before availability

Outputs

Transistor output

Delay time

Relay output

Delay time

Output function - momentary impulse

Output function - continuous signal

Electrical data

Voltage

Power consumption

Power supply for sensor

Ambient conditions

Ambient temperature

Storage temperature

Mechanical data

Weight

Dimensions (L x H x D)

Connection

Maximum permissible core cross-section

single  
5000 h at 25 °C  
battery, charging time  
≥ 50 h

LED green  
2  
8 mm  
via push-button decade  
switches

10 Hz/200 Hz  
50 ms/2.5 ms  
2.3 kΩ (positive logic)  
low: 0 ... 6 V DC  
high: 16 ... 30 V DC

20 ms/4 ms  
< 5 ms  
0.2 s after reclosing

PNP, normally-closed  
collector  
24 V ±15 %, 10 mA  
≤ 10 ms at 10 Hz  
≤ 4 ms at 200 Hz  
change-over contact  
250 V AC, 2 A, cos φ = 1  
≤ 20 ms at 10 Hz  
≤ 14 ms at 200 Hz  
50 ms ... 1 s, adjustable  
with automatic reset  
with external reset

90 ... 132 V AC  
180 ... 264 V AC  
50 ... 60 Hz  
6 VA  
24 V DC, 75 mA ripple  
≤ 3 %

-10 ... 70 °C  
-25 ... 70 °C

approx. 500 g  
72 x 72 x 104 mm  
screw terminals  
0.34 ... 1.5 mm<sup>2</sup>

single  
5000 h at 25 °C  
battery, charging time  
≥ 50 h

LED green  
4  
8 mm  
via push-button decade  
switches

10 Hz/1 kHz  
50 ms/0.5 ms  
2.3 kΩ (positive logic)  
low: 0 ... 6 V DC  
high: 16 ... 30 V DC

10 ms/2 ms  
< 1 ms  
0.2 s after reclosing

PNP, normally-closed  
collector  
24 V ±15 %, 10 mA  
≤ 10 ms at 10 Hz  
≤ 0.8 ms at 1 kHz  
change-over contact  
250 V AC, 2 A, cos φ = 1  
≤ 20 ms at 10 Hz  
≤ 10 ms at 1 kHz  
50 ms ... 1 s, adjustable  
with automatic reset  
with external reset

90 ... 132 V AC  
180 ... 264 V AC  
50 ... 60 Hz  
6 VA  
24 V DC, 75 mA ripple  
≤ 3 %

-10 ... 70 °C  
-25 ... 70 °C

approx. 500 g  
72 x 72 x 104 mm  
screw terminals  
0.34 ... 1.5 mm<sup>2</sup>

single  
5000 h at 25 °C  
battery, charging time  
≥ 50 h

LED green  
6  
8 mm  
via push-button decade  
switches

10 Hz/5 kHz  
50 ms/0.1 ms  
2.3 kΩ (positive logic)  
low: 0 ... 6 V DC  
high: 16 ... 30 V DC

5 ms/1 ms  
< 0.2 ms  
0.2 s after reclosing

PNP, normally-closed  
collector  
24 V ±15 %, 10 mA  
≤ 10 ms at 10 Hz  
≤ 0.15 ms at 5 kHz  
change-over contact  
250 V AC, 2 A, cos φ = 1  
≤ 20 ms at 10 Hz  
≤ 10 ms at 5 kHz  
50 ms ... 1 s, adjustable  
with automatic reset  
with external reset

90 ... 132 V AC  
180 ... 264 V AC  
50 ... 60 Hz  
6 VA  
24 V DC, 75 mA ripple  
≤ 3 %

-10 ... 70 °C  
-25 ... 70 °C

approx. 500 g  
72 x 72 x 104 mm  
screw terminal  
0.34 ... 1.5 mm<sup>2</sup>

KCX-2DM-V  
 KCX-4DM-V  
 KCX-6DM-V

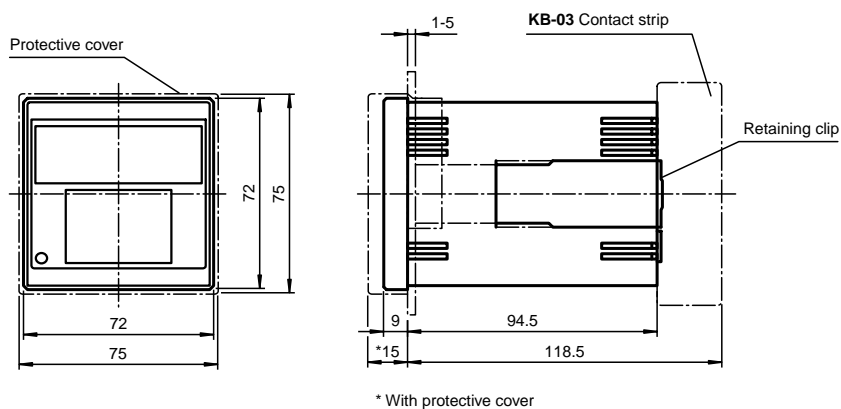

**Additional features**

- Counting frequency up to 5 kHz
- Power supply for pulse counter
- Display storage
- Reset automatic or with external signal
- Flexible protective cover protects the front plate against dust and water spray
- Base for surface mounting or built-in installation
- Base and lockable front frame (ordered separately), see page 40 f

**Electrical connection**

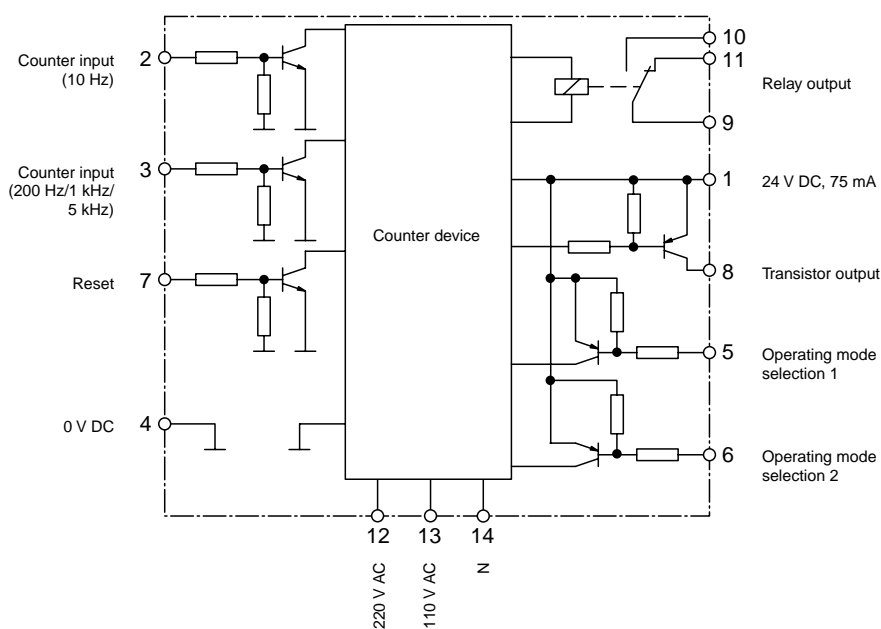

**Controls and indicators**

**Additional data**

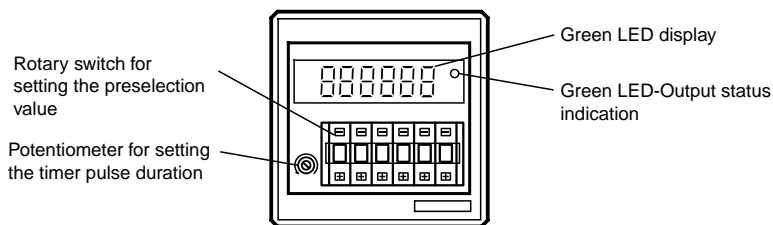

**KF-03, Base for surface mounting**  
**KB-03, Base for built-in installation**

**KF-03, Base for surface mounting**

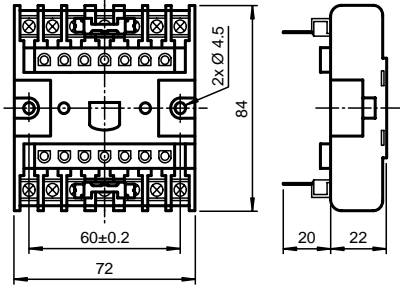

**KB-03, Base for built-in installation**

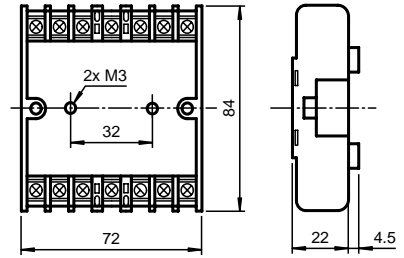

**KF-03, Base fixing**  
**KF-03, Installation cut-out**

**Base fixing KF-03**

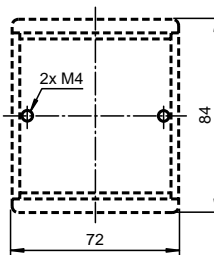

**Installation cut-out**

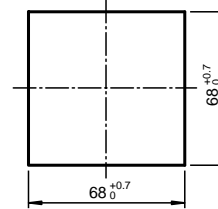

**KA-01, Base for soldered connection**

**KA-01, Base for soldered connection**

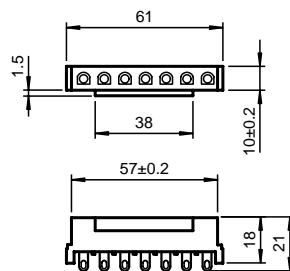

The KA-01 consists of 2 individual bases for solder connection, including the fixing bracket.

FPL-01, Lockable front frame

FPL-01 Lockable front frame

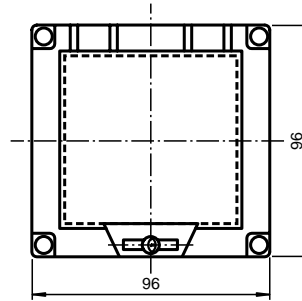

Dimensions relevant to use of the lockable front frame.

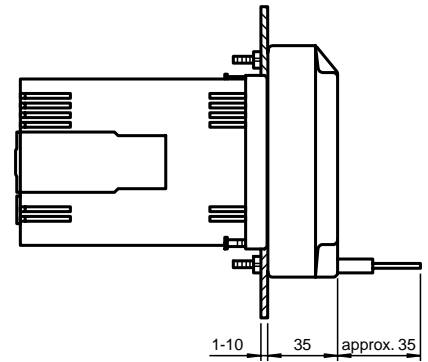

FPL-01, Installation cut-out

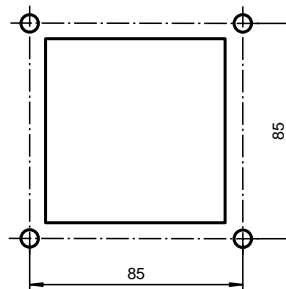

Ø4.5 mm for M4 screws

**Mode A1**

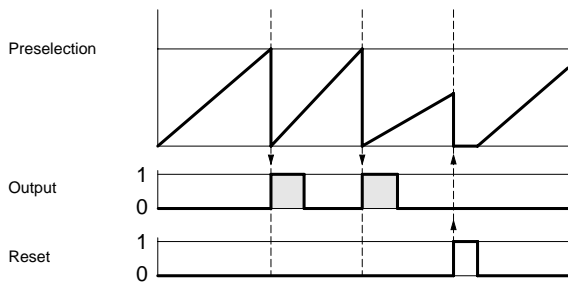

**Mode A2**

Jumper terminals 3-8 (Counter input terminal 2)  
or 2-8 (Counter input terminal 3)

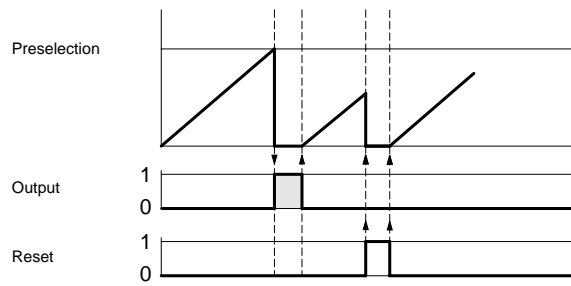

**Mode B1**

Jumper terminals 4-5-6

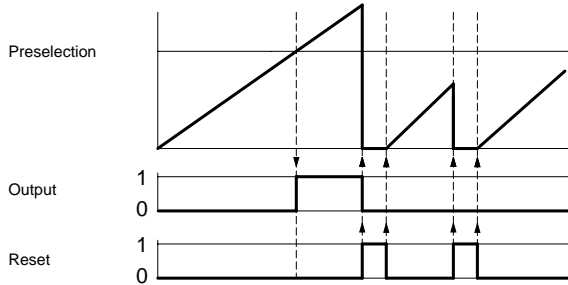

**Mode B2**

Jumper terminals 4-5-6 and 3-8 (Counter input terminal 2)  
or 2-8 (Counter input terminal 3)

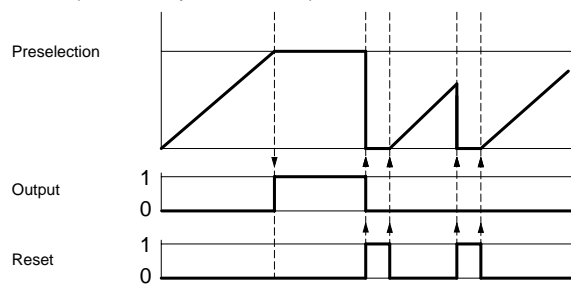

**Mode B3**

Jumper terminals 4-5

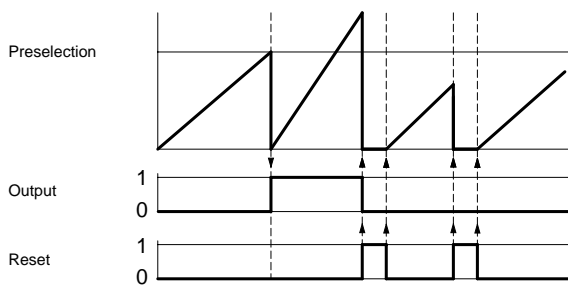

**Mode B4**

Jumpert terminals 4-5 and 3-8 (Counter input terminal 2)  
or 2-8 (Counter input terminal 3)

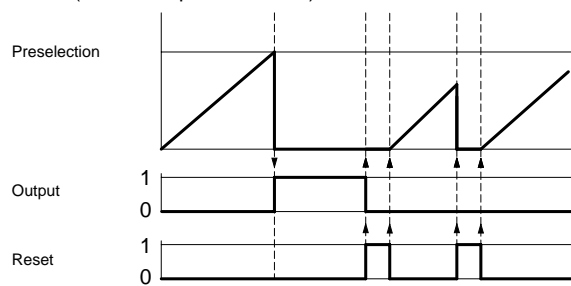

 Indicates "Momentary impulse output" (50 ms ... 1s)