

⚠ WARNING / 警告
RISK OF FIRE OR ELECTRIC SHOCK (FOR CONTACTOR WITH UL HI-FAULT SHORT CIRCUIT CURRENT RATINGS ONLY)
 The opening of the branch-circuit protective device may be an indication that a fault current has been interrupted.
 To reduce the risk of the fire or electrical shock, current-carrying parts and other components of the controller should be examined and replaced if damaged.
Failure to follow these instructions can result in death, serious injury, or equipment damage.
 可能有火灾或者触电的危险（仅限UL高故障短路电流额定值的接触器）。
 支路保护设备断开，表明故障电流已被中断。
 为降低火灾或触电风险，应检查带电部件和其它控制元件，如有损坏，需及时更换。
 不遵循上述说明可能导致人员伤亡或设备损坏。

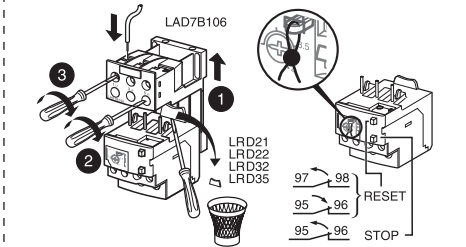

W9 1645523 0211 A07
 04 - 2016

Schneider Electric Industries SAS
 35, rue Joseph Monier
 92506 Rueil Malmaison
 France

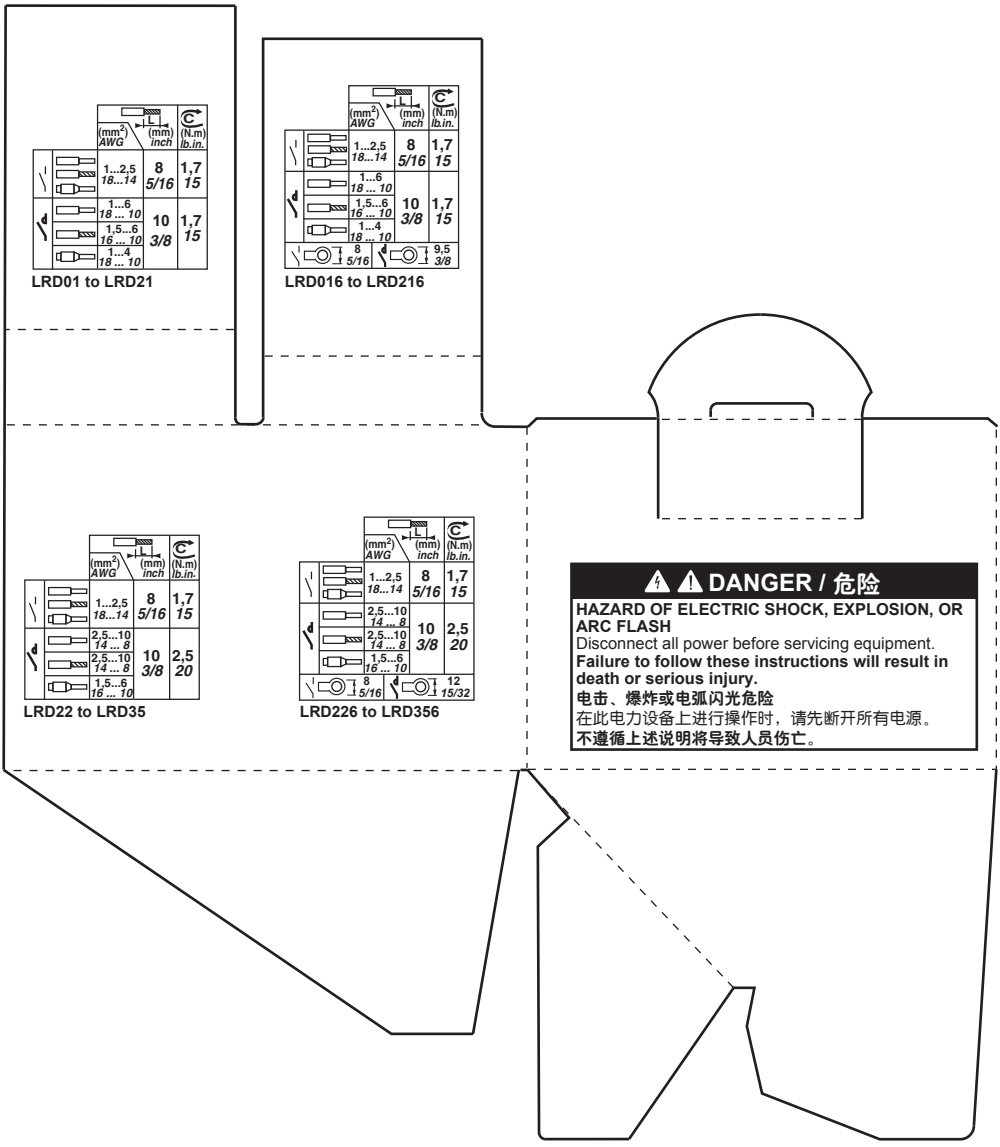

	(mm ²) AWG	(mm) inch	(N.m) lb.in.
V	1...2,5 18...14	8 5/16	1,7 15
	1...6 18...10	10	1,7 15
d	1,5...6 16...10	3/8	1,7 15
	1...4 18...10		

LRD01 to LRD21

	(mm ²) AWG	(mm) inch	(N.m) lb.in.
V	1...2,5 18...14	8 5/16	1,7 15
	1...6 18...10	10	1,7 15
d	1,5...6 16...10	3/8	1,7 15
	1...4 18...10		
V		8 5/16	9,5 3/8

LRD016 to LRD216

	(mm ²) AWG	(mm) inch	(N.m) lb.in.
V	1...2,5 18...14	8 5/16	1,7 15
	2,5...10 14...8	10	2,5 20
d	2,5...10 14...8	3/8	2,5 20
	1,5...6 16...10		

LRD22 to LRD35

	(mm ²) AWG	(mm) inch	(N.m) lb.in.
V	1...2,5 18...14	8 5/16	1,7 15
	2,5...10 14...8	10	2,5 20
d	2,5...10 14...8	3/8	2,5 20
	1,5...6 16...10		
V		8 5/16	12 15/32

LRD226 to LRD356

⚠ ⚠ DANGER / 危险
HAZARD OF ELECTRIC SHOCK, EXPLOSION, OR ARC FLASH
 Disconnect all power before servicing equipment.
Failure to follow these instructions will result in death or serious injury.
 电击、爆炸或电弧闪光危险
 在此电力设备上进行操作时，请先断开所有电源。
 不遵循上述说明将导致人员伤亡。